

Nr.19984

Lewmar 43ST

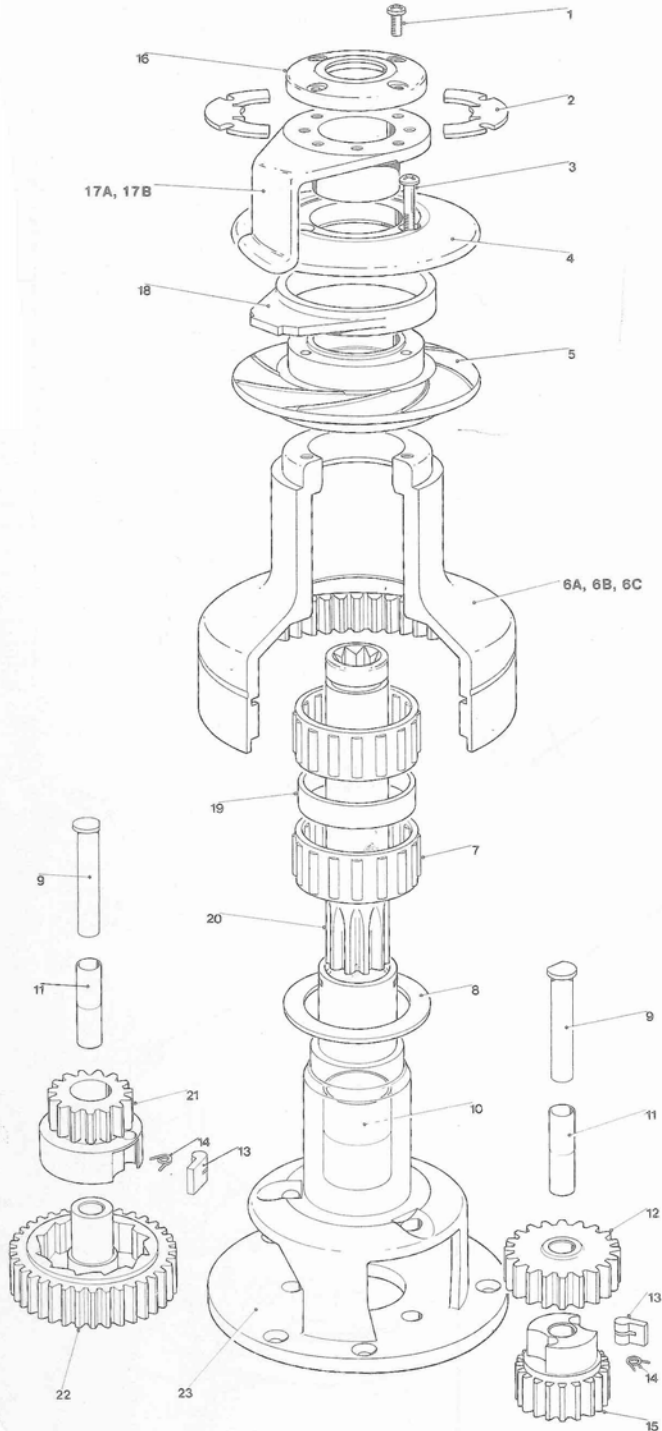

No. 43 2 Speed Self Tailing Winch

| Item No. | Part No. | Description | No. Off |
|----------|----------|---|---------|
| 1 | B0325 | Pan Hd Posidriv Screw M5 x 12mm Long | 4 |
| 2 | 15000387 | Collet | 2 |
| 3 | B0325 | Pan Hd Posidriv M5 x 40mm | 3 |
| 4 | 15000414 | Upper Crown | 1 |
| 5 | 15000415 | Lower Crown | 1 |
| 6A | 15000410 | Drum - Chrome | 1 |
| 6B | 15000411 | Drum - Alloy | 1 |
| 6C | 15000666 | Drum - Bronze | 1 |
| 7 | 1501007 | Roller Bearing | 2 |
| 8 | 15034638 | Drum Washer | 1 |
| 9 | 15000422 | Gear Spindle | 2 |
| 10 | 15000377 | Main Spindle Sleeve Fitted with Item 23 | 2 |
| 11 | 15000398 | Gear Spindle Sleeve | 4 |
| 12 | 15000418 | Ratchet Gear | 1 |
| 13 | 1260/8 | Pawl | 4 |
| 14 | 1260/7 | Spring | 4 |
| 15 | 15000397 | Pawl Gear | 1 |
| 16 | 15000379 | Top Cap | 1 |
| 17A | 15000412 | Feeder Arm - Chrome | 1 |
| 17B | 15000673 | Feeder Arm - Bronze | 1 |
| 18 | 15000413 | Stripper Ring | 1 |
| 19 | 15010008 | Spacer | 1 |
| 20 | 15000837 | Main Spindle | 1 |
| 21 | 15000419 | Pawl Gear | 1 |
| 22 | 15000417 | Ratchet Gear | 1 |
| 23 | 15000408 | Centre Stem | 1 |

Es sind
keine
Ersatzteile
mehr
lieferbar
Baureihe 1990

Marina Großenbrode

keine Ersatzteile lieferbar

- 1 Gear Spindle
- 2 Bearing Sleeve
- 3 Pawl
- 4 Pawl Spring
- 5 Pawl Gear
- 6 Washer
- 7 Seal
- 8 Input Shaft
- 9 Base 43
- 10 Bearing
- 11 Sleeve
- 12 Collets
- 13 Retainer
- 14 Screw
- 15 Adapter Plate

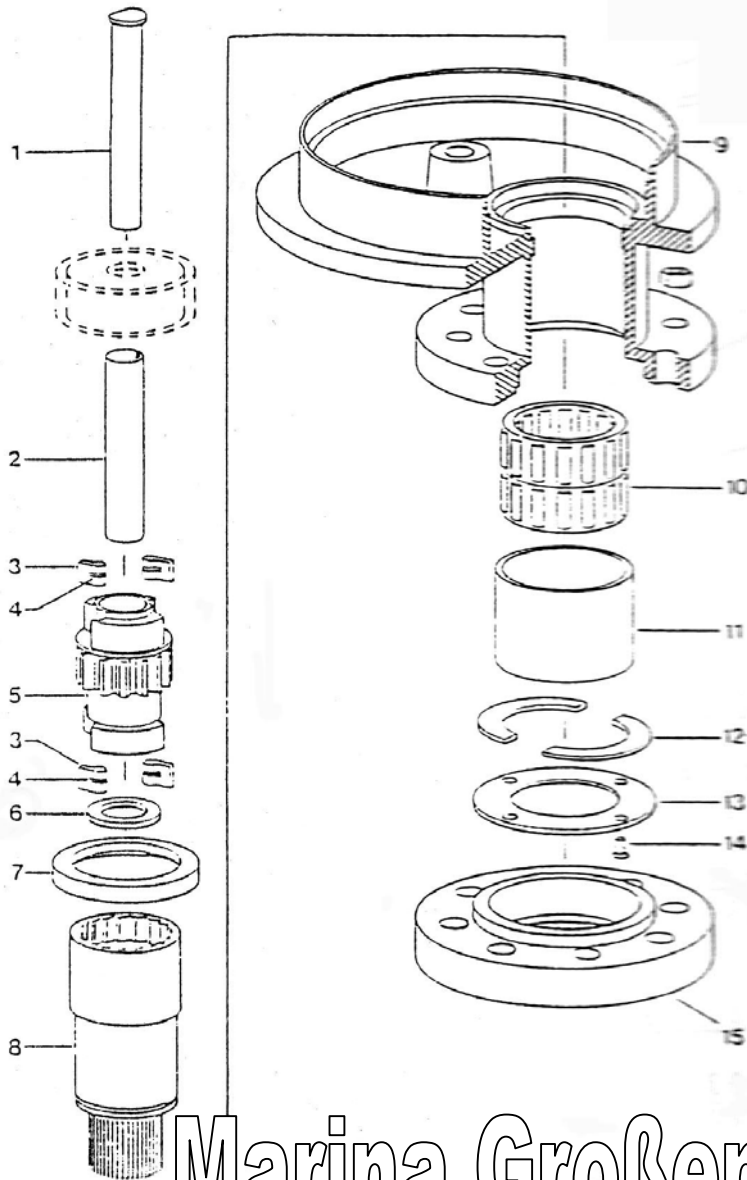

Marina Großenbrode

keine Ersatzteile lieferbar



Marina Großenbrode